



Sunrise View

Offers In Excess Of £400,000

887sq ft - Cosway Estates are pleased to offer for sale this well presented 2 double bedroom ground floor flat situated in a sought after development overlooking Mill Hill Park. The property is situated on the ground floor of this purpose built block and comprises of a bright and airy living room leading onto a balcony. A separate fully equipped kitchen - breakfast room, in addition to a master bedroom with fitted wardrobes, a further double bedroom and a modern family bathroom with a separate w/c, further benefits include new flooring, updated heating system, ample storage, allocated parking, within catchment of local schools, excellent transport links, and within close proximity to the amenities of Mill Hill. Viewing Highly Recommended. Long lease 949 years remaining . Sole Agents.

Viewing

Please contact our Mill Hill Office on 020 8959 0011 if you wish to arrange a viewing appointment for this property or require further information.

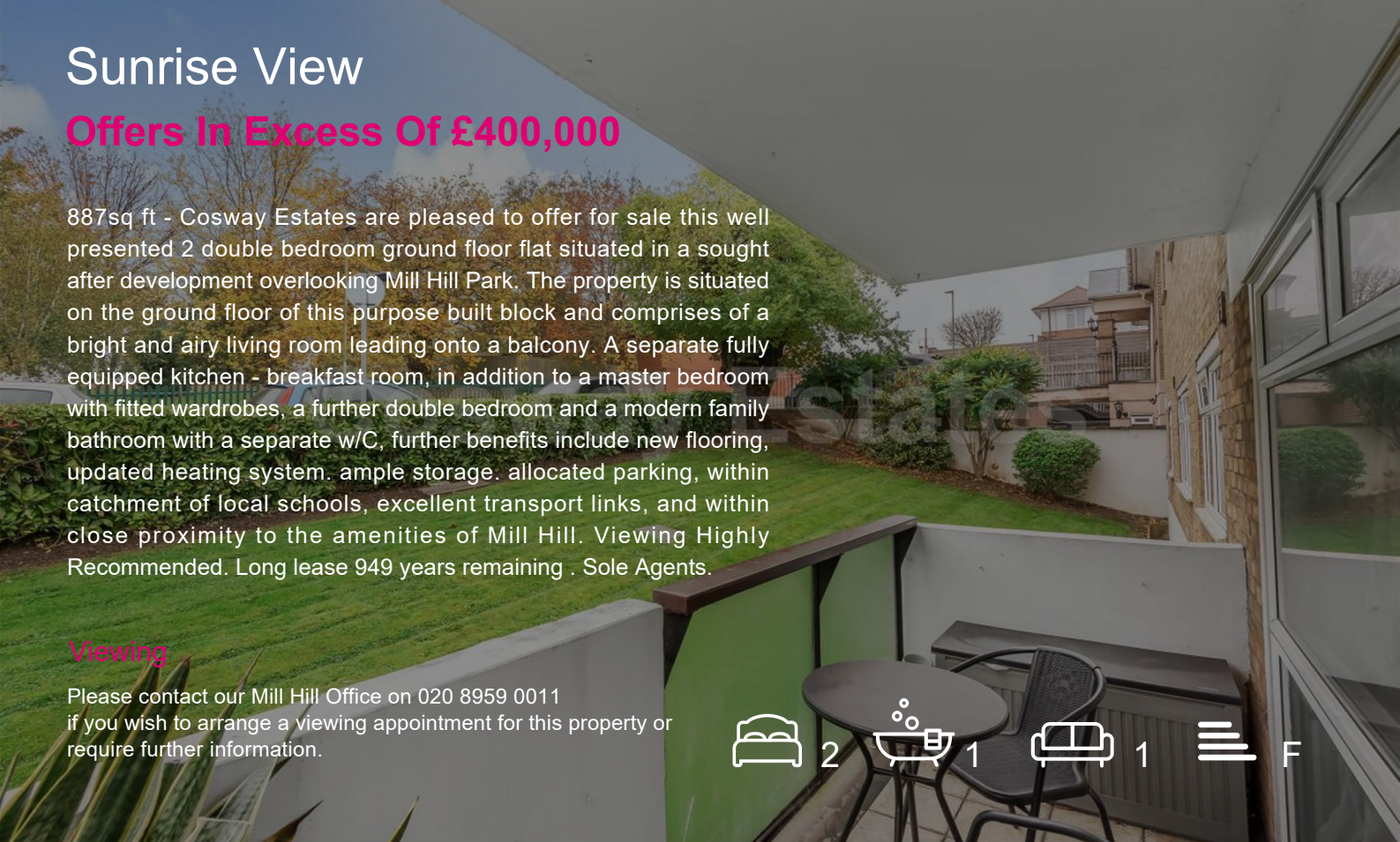

Floor Plan

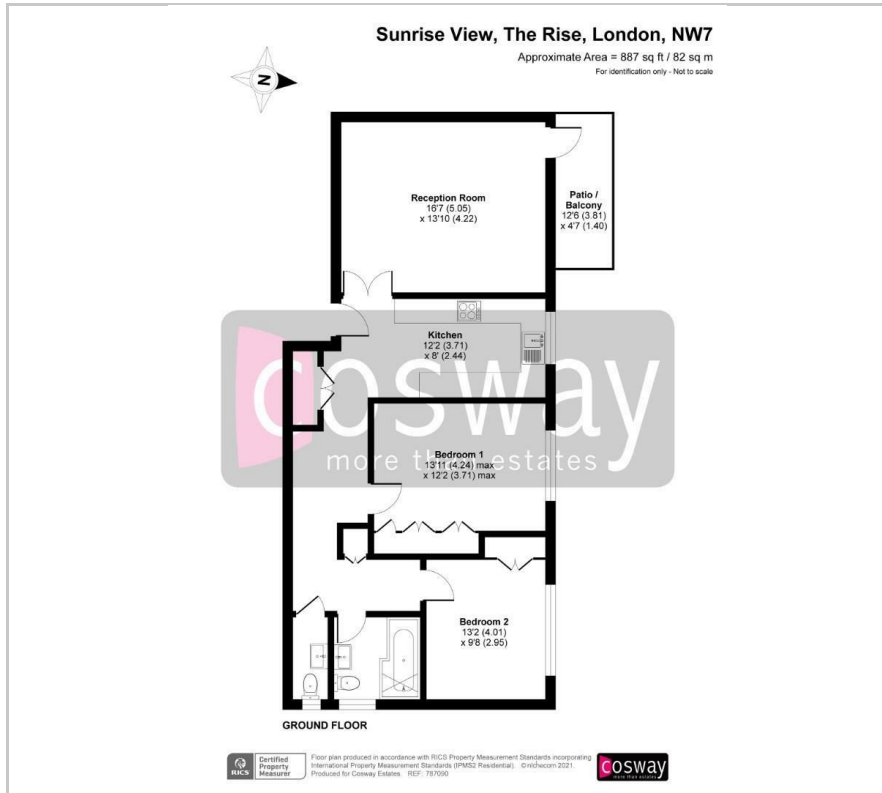

Area Map

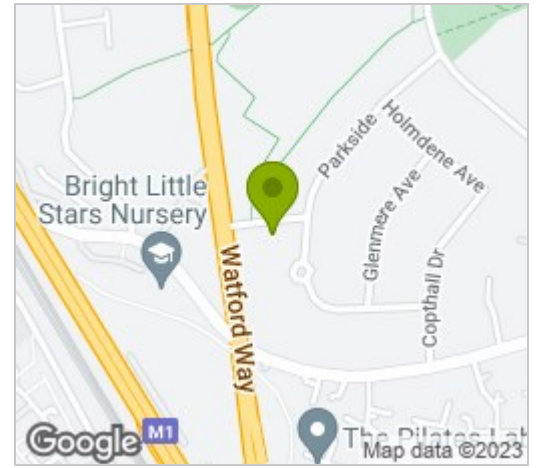

Energy Efficiency Graph

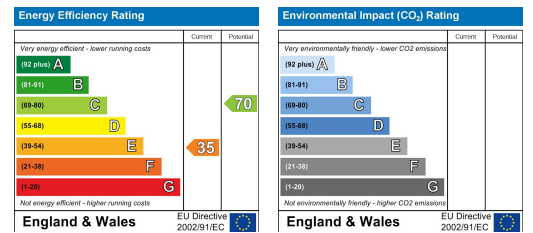

These particulars, whilst believed to be accurate are set out as a general outline only for guidance and do not constitute any part of an offer or contract. Intending purchasers should not rely on them as statements of representation of fact, but must satisfy themselves by inspection or otherwise as to their accuracy. No person in this firm's employment has the authority to make or give any representation or warranty in respect of the property.